

## Fill / Flow Sub DYNWELL Ported / Non Ported

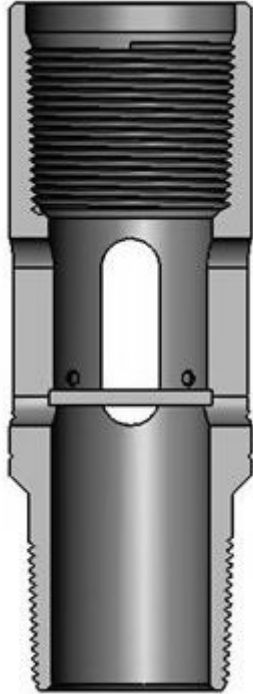

### Technical Information

**SPECIFICATIONS:**

TEMPERATURE RATING  
230 °C 450 °F

DESIGNED TO ALLOW TUBING STRING TO FILL UP WHILE RUNNING AS WELL AS SERVE AS A FLOW PASSAGE FOR RESERVOIR FLUIDS TO ENTER THE TUBING DURING PRODUCTION. A GLASS DISC KEEPS DEBRIS FROM SETTLING ON TOP OF THE MECHANICAL ACTUATED FIRING HEAD.

**RECOMMENDATIONS:**

IN ORDER TO ENSURE THE PROPER OPERATION IT IS RECOMMENDED TO USE THE APPROPRIATE REDRESS KITS FOR EACH RUN.

**AVAILABLE SIZES:**

ALSO AVAILABLE AS NON PORTED TYPE

Manufactured by LRI

Size	60mm / 2.375"	73mm / 2.875"
Maximum O.D.	77,8mm / 3.063"	93,2mm / 3.668"
Connection	2 3/8" EU PIN	2 7/8" EU PIN
Minimum I.D.	50.7mm / 1.995"	62mm / 2.441"

Revision: RP04009AA

### Selection Chart

Part No.	Size (mm / in)	Max. O.D. (mm / in)	Weight (kg)	Dimensions (mm)	Part No. Redress Kit
PORTED 2316766	60 / 2.375	78.0 / 3.062	3.4	222,3 x 77.8	2316767
NON PORTED 2316768			3.5		
PORTED 2316790	73 / 2.875	94.0 / 3.688	4.5	228,4 x 93,2	2316791
NON PORTED 2316792			4.6		